

PART ORDERING INFORMATION:

2-"FACE LENGTH"-**"OVERALL LENGTH"**-12002A

INCHES

INCHES

LEAVE OUT IF NO
SHAFT REQUIRED

NOTE: 2.0" O.D. x .188 WALL 6061 ALUMINUM TUBING
.003 MAX. T.I.R.
.003 MAX. TAPER
DYNAMICALLY BALANCED G2.5
O.D. POLISHED 20R_a
LOW FRICTION ER-8 BEARINGS
1045 STEEL THROUGH SHAFT

ROCKFORD ROLLER CORP.

10527 PRODUCT DR. MACHESNEY PARK IL 61115 (815)282-2234

SCALE		DRAWN	DJ
UNITS	ENGLISH	DATE	4-7-09

DRAWING NUMBER

A-12002

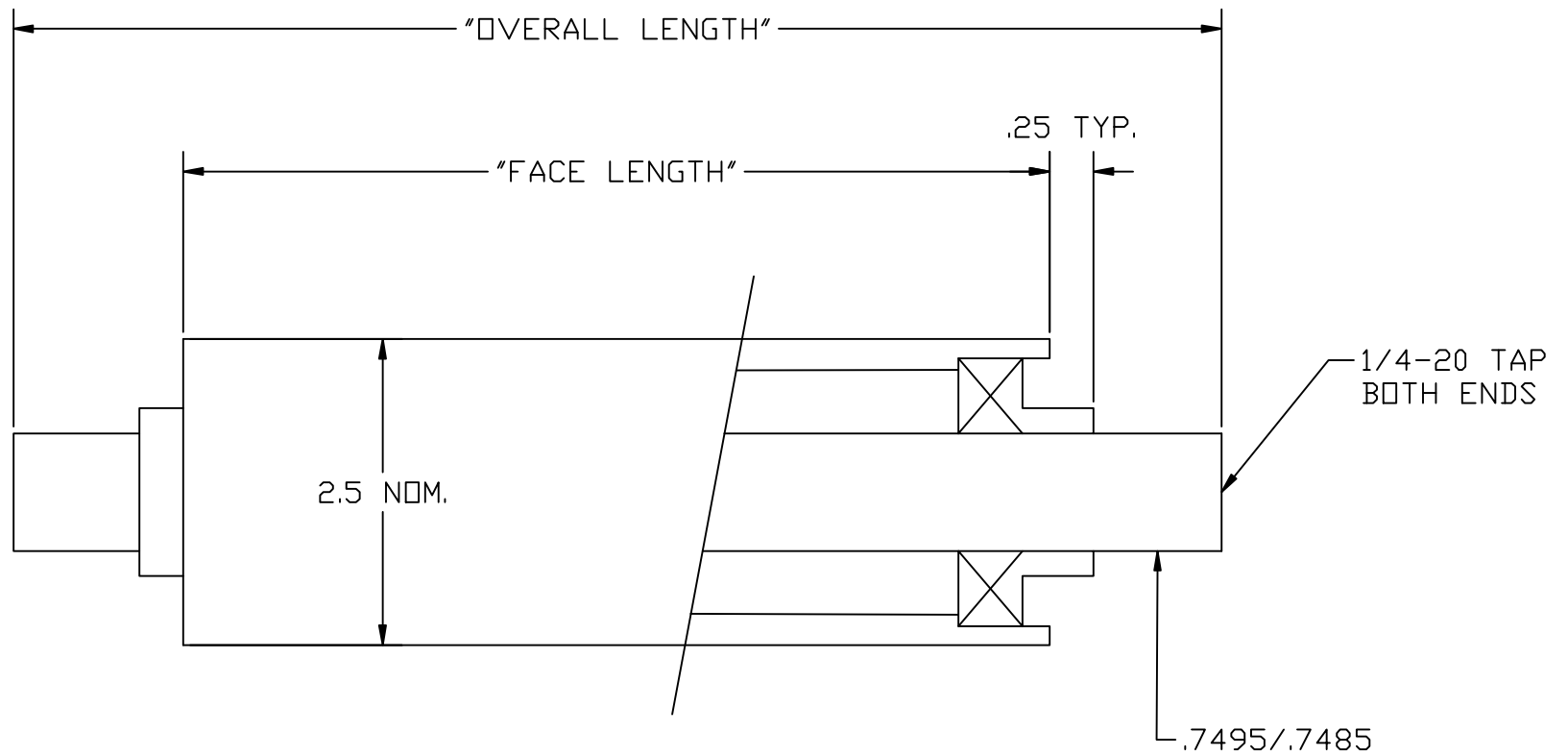

PART ORDERING INFORMATION:

2.5-"FACE LENGTH"-**"OVERALL LENGTH"**-12051A
 INCHES INCHES

LEAVE OUT IF NO
 SHAFT REQUIRED

NOTE: 2.5" O.D. x .375 WALL 6061 ALUMINUM TUBING
 .003 MAX. T.I.R.
 .003 MAX. TAPER
 DYNAMICALLY BALANCED G2.5
 O.D. POLISHED 20R_a
 LOW FRICTION ER-12 BEARINGS
 1045 STEEL THROUGH SHAFT

ROCKFORD ROLLER CORP.		
10527 PRODUCT DR. MACHESNEY PARK IL 61115 (815)282-2234		
SCALE		DRAWN DJ
UNITS ENGLISH		DATE 4-7-09
DRAWING NUMBER		A-12051

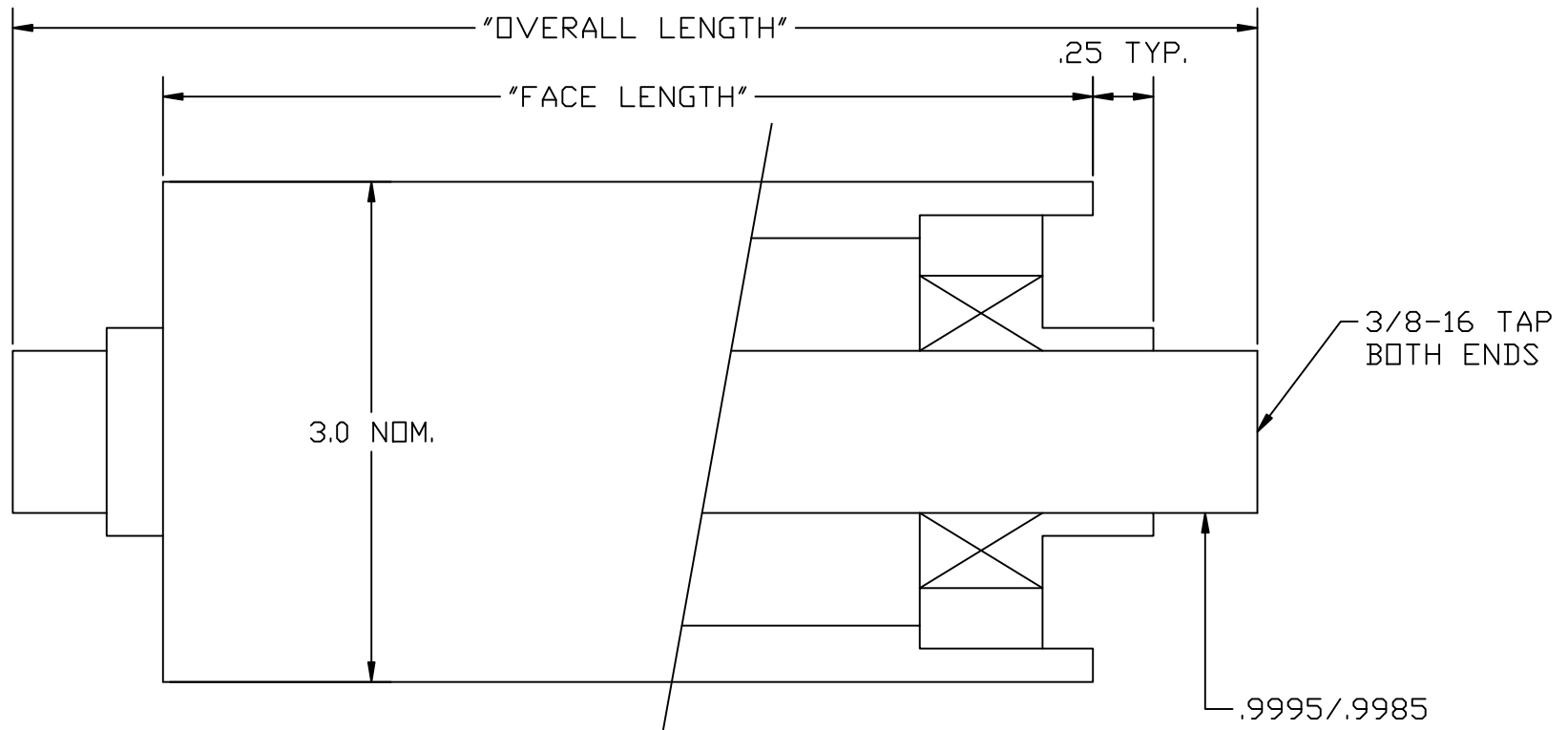

PART ORDERING INFORMATION:

3-"FACE LENGTH"- "OVERALL LENGTH"-12101A
 INCHES INCHES

LEAVE OUT IF NO
 SHAFT REQUIRED

NOTE: 3.0" O.D. x .25 WALL 6061 ALUMINUM TUBING
 .003 MAX. T.I.R.
 .003 MAX. TAPER
 DYNAMICALLY BALANCED G2.5
 O.D. POLISHED 20R_a
 LOW FRICTION ER-16 BEARINGS
 1045 STEEL THROUGH SHAFT

ROCKFORD ROLLER CORP.		
10527 PRODUCT DR. MACHESNEY PARK IL 61115 (815)282-2234		
SCALE		DRAWN DJ
UNITS ENGLISH		DATE 4-7-09
DRAWING NUMBER		A-12101

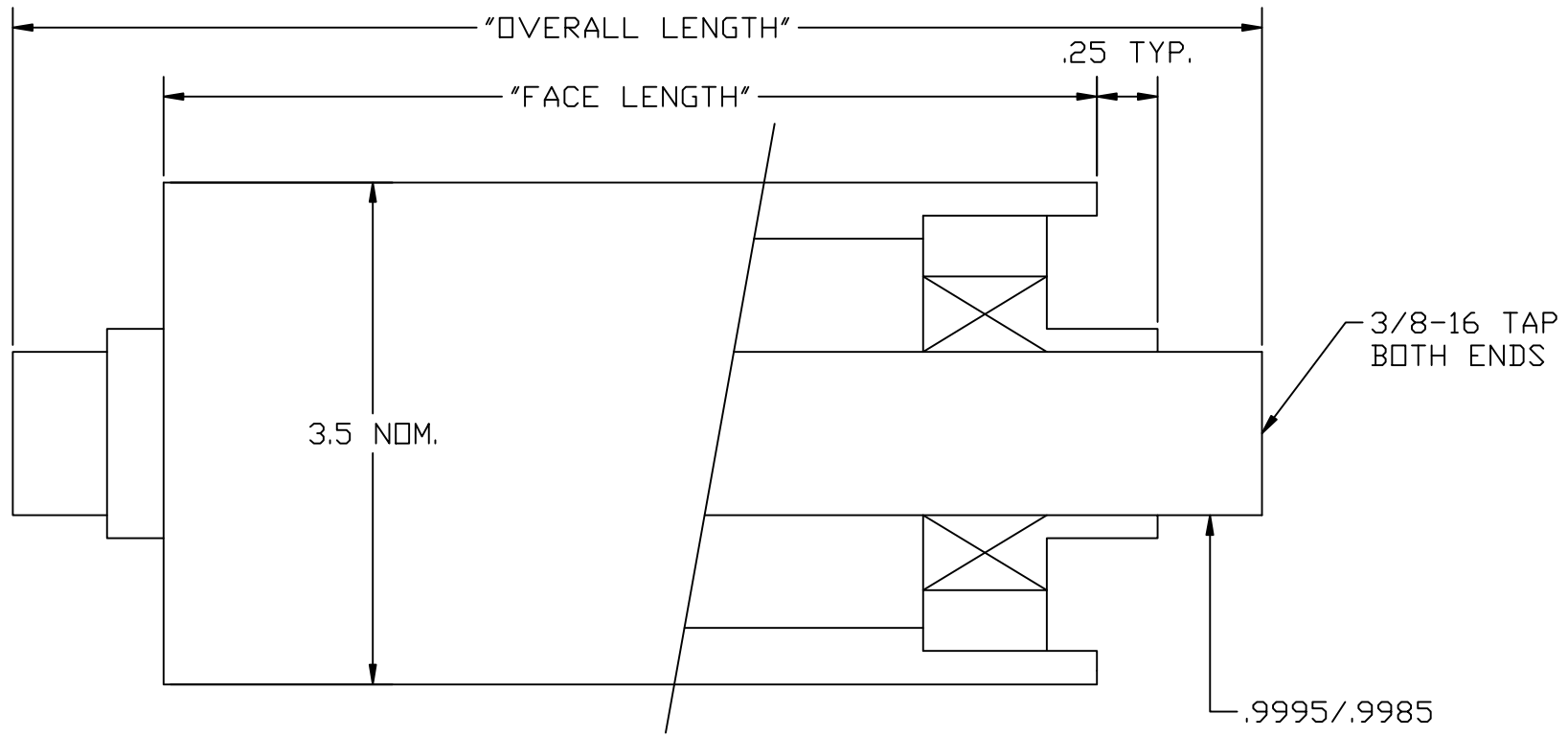

PART ORDERING INFORMATION:
 3.5-"FACE LENGTH"- "OVERALL LENGTH"-12200A
 INCHES INCHES
 LEAVE OUT IF NO
 SHAFT REQUIRED

NOTE: 3.5" O.D. x .313 WALL 6061 ALUMINUM TUBING
 .003 MAX. T.I.R.
 .003 MAX. TAPER
 DYNAMICALLY BALANCED G2.5
 O.D. POLISHED 20R_a
 LOW FRICTION ER-16 BEARINGS
 1045 STEEL THROUGH SHAFT

ROCKFORD ROLLER CORP.		
10527 PRODUCT DR. MACHESNEY PARK IL 61115 (815)282-2234		
SCALE		DRAWN DJ
UNITS ENGLISH		DATE 4-7-09
		DRAWING NUMBER
		A-12200

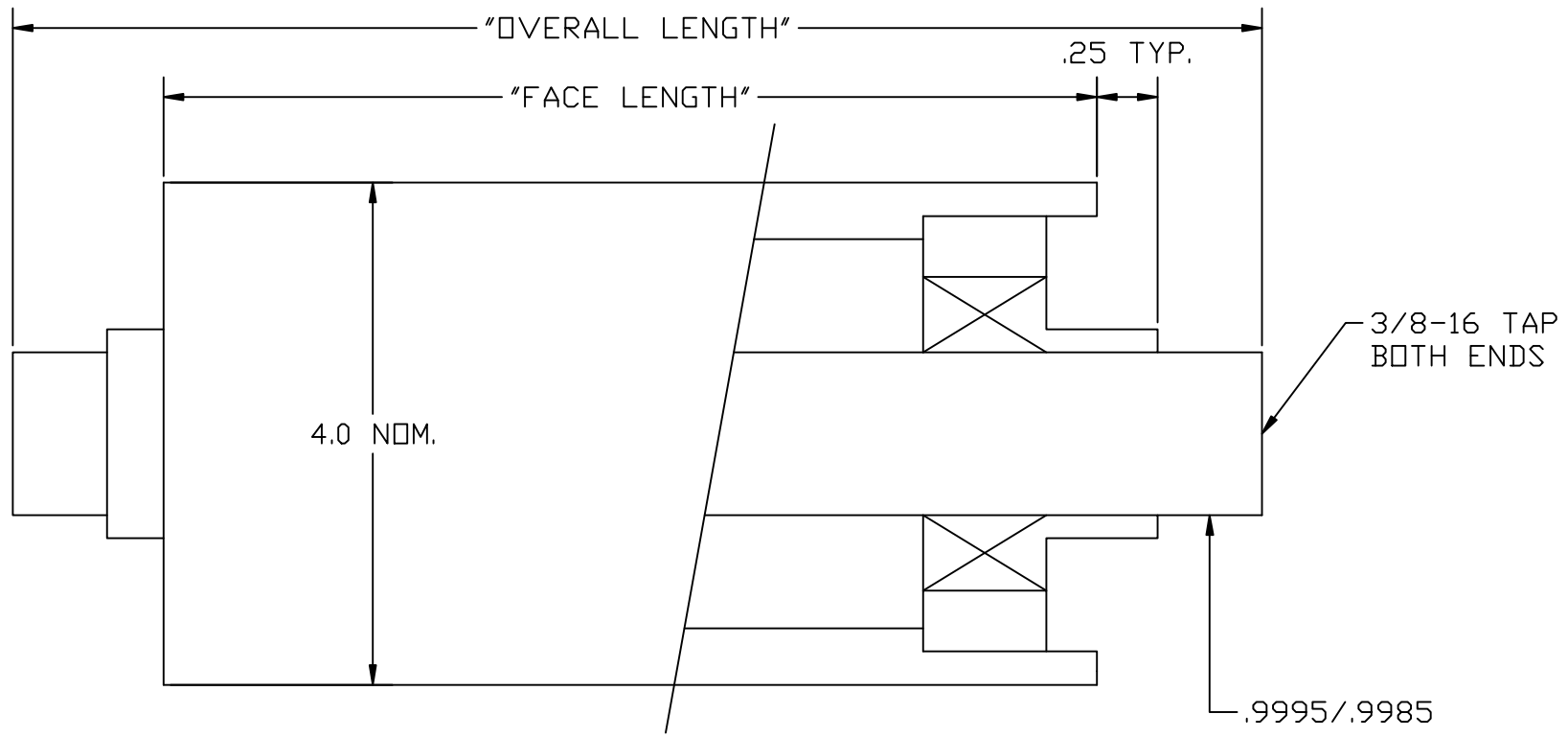

PART ORDERING INFORMATION:
 4-"FACE LENGTH"-
 INCHES
 "OVERALL LENGTH"-12300A
 INCHES
 LEAVE OUT IF NO
 SHAFT REQUIRED

NOTE: 4.0" O.D. x .250 WALL 6061 ALUMINUM TUBING
 .003 MAX. T.I.R.
 .003 MAX. TAPER
 DYNAMICALLY BALANCED G2.5
 O.D. POLISHED 20R_a
 LOW FRICTION ER-16 BEARINGS
 1045 STEEL THROUGH SHAFT

ROCKFORD ROLLER CORP.		
10527 PRODUCT DR. MACHESNEY PARK IL 61115 (815)282-2234		
SCALE		DRAWN DJ
UNITS ENGLISH		DATE 4-7-09
DRAWING NUMBER		A-12300

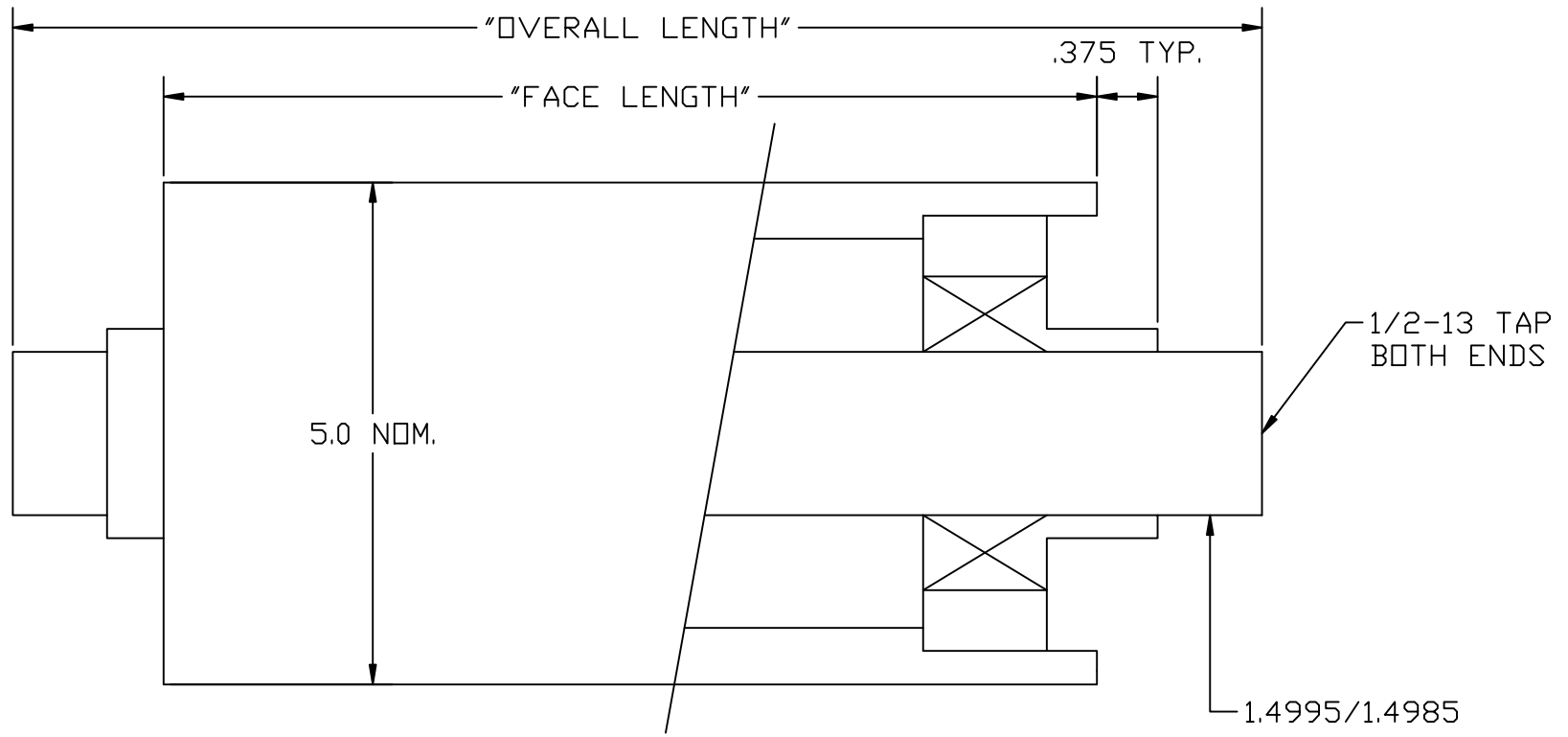

PART ORDERING INFORMATION:
 5-"FACE LENGTH"- "OVERALL LENGTH"-12400A
 INCHES INCHES
 LEAVE OUT IF NO
 SHAFT REQUIRED

NOTE: 5.0" O.D. x .50 WALL 6061 ALUMINUM TUBING
 .003 MAX. T.I.R.
 .003 MAX. TAPER
 DYNAMICALLY BALANCED G2.5
 O.D. POLISHED 20R_a
 LOW FRICTION ER-24 BEARINGS
 1045 STEEL THROUGH SHAFT

ROCKFORD ROLLER CORP.		
10527 PRODUCT DR. MACHESNEY PARK IL 61115 (815)282-2234		
SCALE		DRAWN DJ
UNITS ENGLISH		DATE 4-7-09
		DRAWING NUMBER
		A-12400

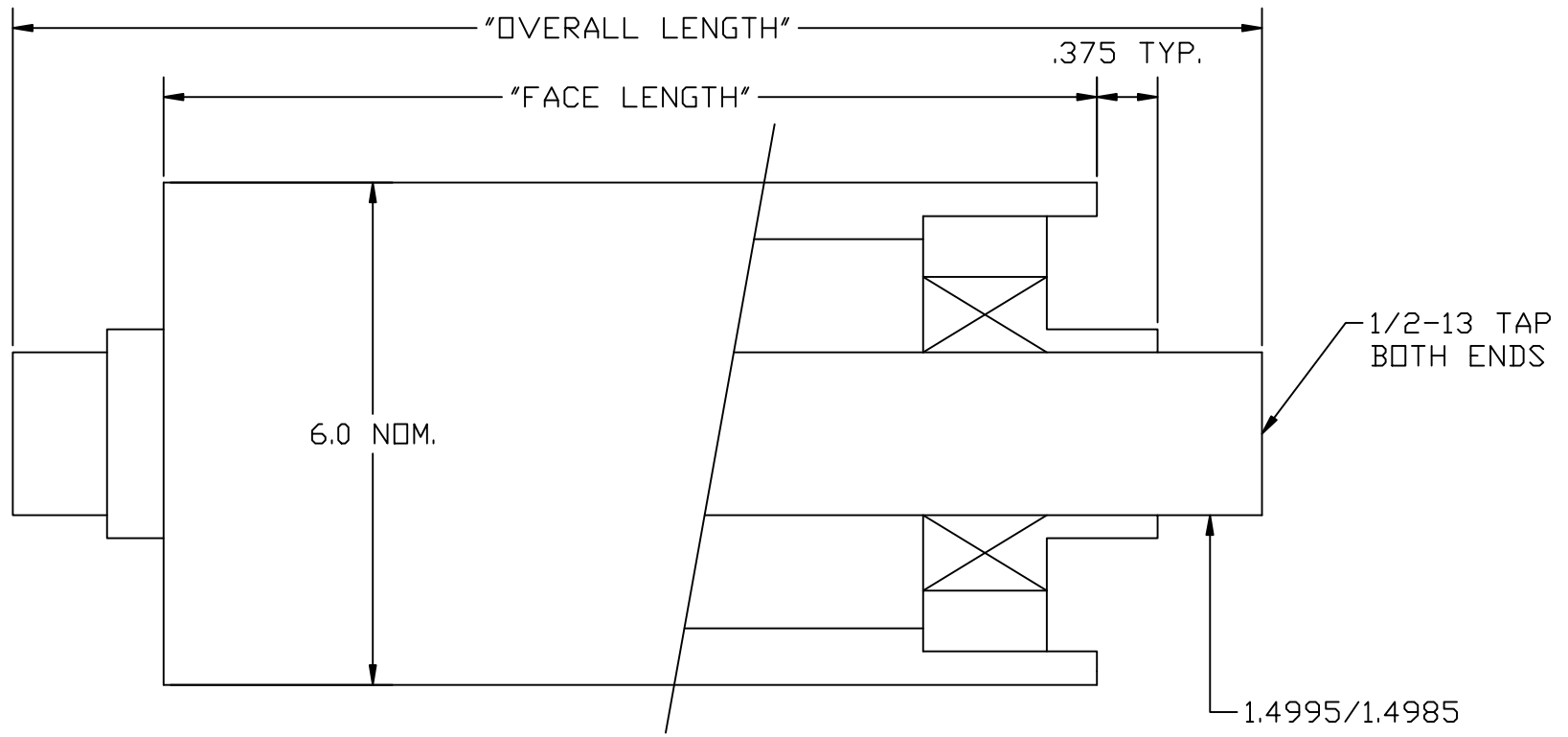

PART ORDERING INFORMATION:

6-"FACE LENGTH"- "OVERALL LENGTH"-12500A
 INCHES INCHES
 LEAVE OUT IF NO
 SHAFT REQUIRED

NOTE: 6.0" O.D. x .50 WALL 6061 ALUMINUM TUBING
 .003 MAX. T.I.R.
 .003 MAX. TAPER
 DYNAMICALLY BALANCED G2.5
 O.D. POLISHED 20R_a
 LOW FRICTION ER-24 BEARINGS
 1045 STEEL THROUGH SHAFT

ROCKFORD ROLLER CORP.		
10527 PRODUCT DR. MACHESNEY PARK IL 61115 (815)282-2234		
SCALE		DRAWN DJ
UNITS ENGLISH		DATE 4-7-09
DRAWING NUMBER		A-12500