

PART ORDERING INFORMATION:

3.5—"FACE LENGTH"—"OVERALL LENGTH"—13200S
 INCHES INCHES

LEAVE OUT IF NO
 SHAFT REQUIRED

NOTE: 3.5" O.D. x .313 WALL 1020 STEEL TUBING
 .003 MAX. T.I.R.
 .003 MAX. TAPER
 DYNAMICALLY BALANCED G2.5
 O.D. POLISHED 20R_a
 LOW FRICTION ER-16 BEARINGS
 1045 STEEL THROUGH SHAFT

ROCKFORD ROLLER CORP.

10527 PRODUCT DR. MACHESNEY PARK IL 61115 (815)282-2234

SCALE		DRAWN	DJ
UNITS	ENGLISH	DATE	4-7-09

DRAWING NUMBER

A-13200

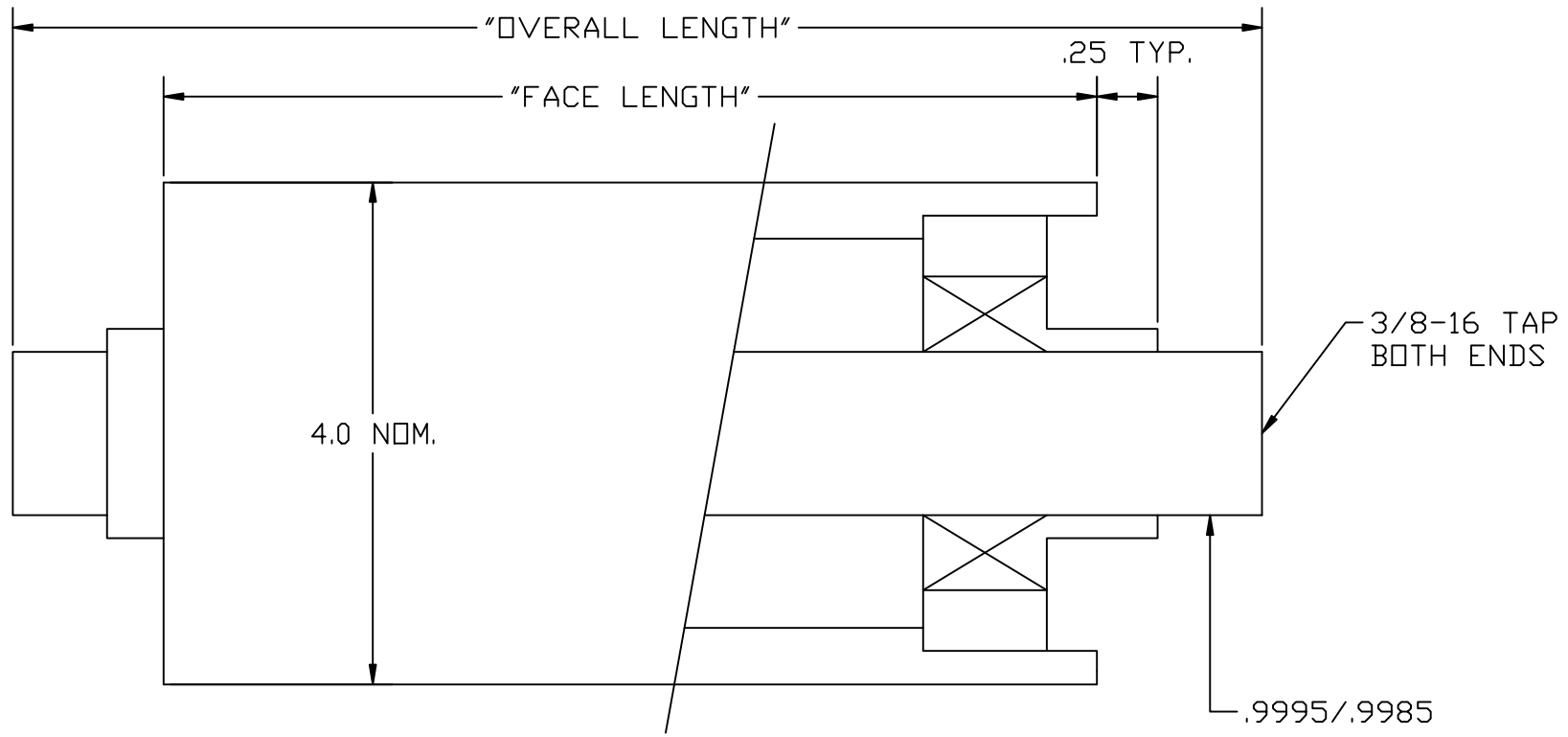

PART ORDERING INFORMATION:

4-"FACE LENGTH"-
INCHES

"OVERALL LENGTH"-13300S
INCHES

LEAVE OUT IF NO
SHAFT REQUIRED

NOTE: 4.0" O.D. x .250 WALL 1020 STEEL TUBING
 .003 MAX. T.I.R.
 .003 MAX. TAPER
 DYNAMICALLY BALANCED G2.5
 O.D. POLISHED 20R_a
 LOW FRICTION ER-16 BEARINGS
 1045 STEEL THROUGH SHAFT

ROCKFORD ROLLER CORP.		
10527 PRODUCT DR. MACHESNEY PARK IL 61115 (815)282-2234		
SCALE		DRAWN DJ
UNITS ENGLISH		DATE 4-7-09
		DRAWING NUMBER
		A-13300

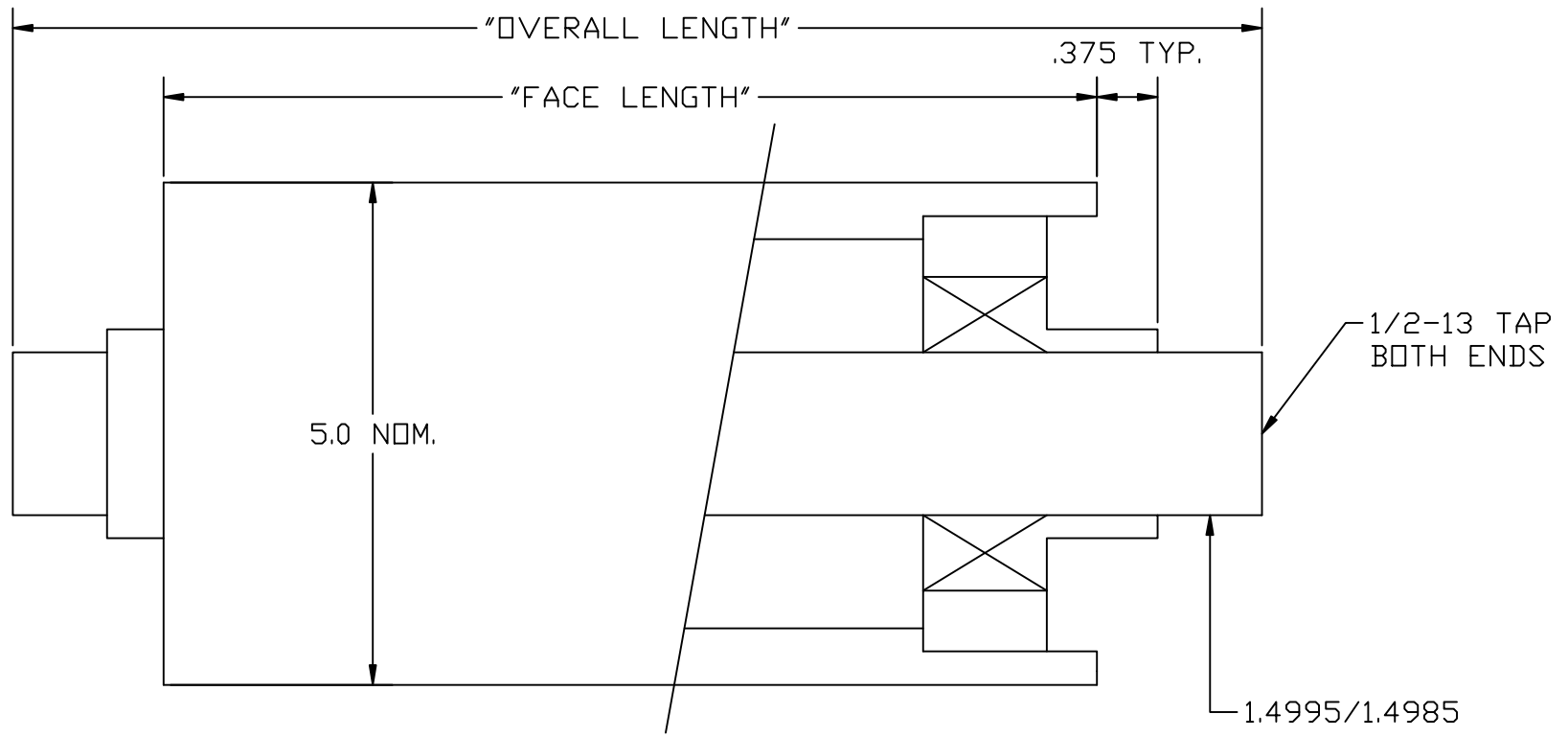

PART ORDERING INFORMATION:
 5-"FACE LENGTH"- "OVERALL LENGTH"-13400S
 INCHES INCHES
 LEAVE OUT IF NO
 SHAFT REQUIRED

NOTE: 5.0" O.D. x .375 WALL 1020 STEEL TUBING
 .003 MAX. T.I.R.
 .003 MAX. TAPER
 DYNAMICALLY BALANCED G2.5
 O.D. POLISHED 20R_a
 LOW FRICTION ER-24 BEARINGS
 1045 STEEL THROUGH SHAFT

ROCKFORD ROLLER CORP.		
10527 PRODUCT DR. MACHESNEY PARK IL 61115 (815)282-2234		
SCALE		DRAWN DJ
UNITS ENGLISH		DATE 4-7-09
DRAWING NUMBER		A-13400

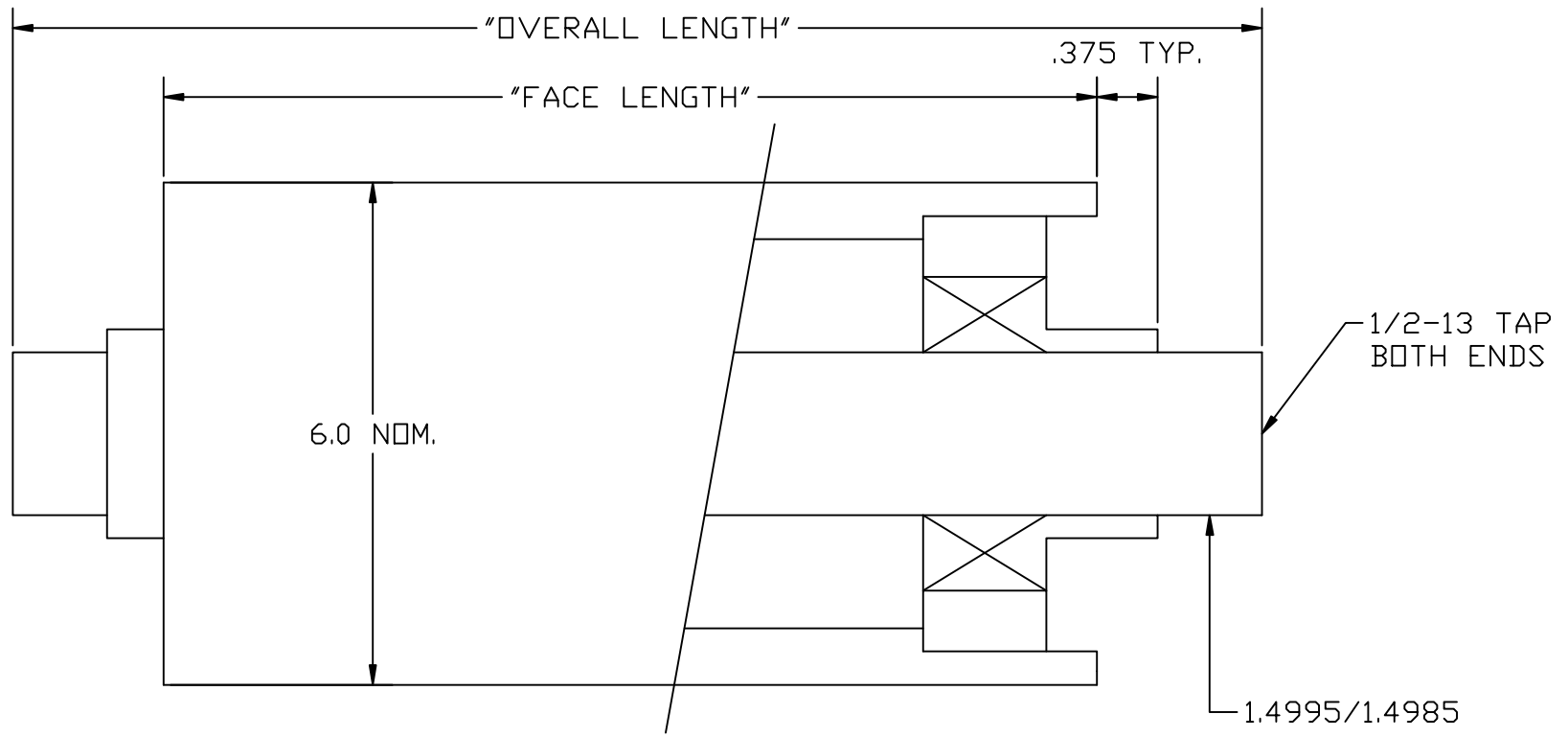

PART ORDERING INFORMATION:

6-"FACE LENGTH"-
INCHES
 "OVERALL LENGTH"-13500S
 INCHES
 LEAVE OUT IF NO
 SHAFT REQUIRED

NOTE: 6.0" O.D. x .375 WALL 1020 STEEL TUBING
 .003 MAX. T.I.R.
 .003 MAX. TAPER
 DYNAMICALLY BALANCED G2.5
 O.D. POLISHED 20R_a
 LOW FRICTION ER-24 BEARINGS
 1045 STEEL THROUGH SHAFT

ROCKFORD ROLLER CORP.		
10527 PRODUCT DR. MACHESNEY PARK IL 61115 (815)282-2234		
SCALE		DRAWN DJ
UNITS ENGLISH		DATE 4-7-09
DRAWING NUMBER		A-13500